

## Cam switches, for building-in, SK63 D



### Ordering code

SK 63 -  ID

Mounting  
 legend plate, black knob  
**C** yellow legend plate, red knob  
**Z** legend plate, black knob, lockable  
**ZC** yellow legend plate, red knob, lockable

Length of the shaft with a lock  $L_o$

**100** 100 mm  
**150** 150 mm  
**200** 200 mm  
**300** 300 mm

Assembly number

**2.423** Disconnecter 0-1 (3 - pole)  
**2.4226** Disconnecter 0-1 (4 - pole)  
**3.4315** Disconnecter 1-0-2 (3 - pole)

Current  
**63** 63 A

For special customer request it is possible to produce switches with different switching programs and without mechanical interlock.

It is recommended that TS35 rail, on which the switch will be mounted, is installed on supports (not directly on the base).

### Components

#### Fronts of cam switches

**Front I SK100-1408 for assemblies D...** (mounted directly on the door with a mechanical lock)

**Front III SK100-1410 for assemblies D...** (padlockable, mounted directly on the door with a mechanical lock)

#### Shafts

Shaft with a lock SK100-1901

Axle coupling, complete SK100-1900\R01

### Dimensions

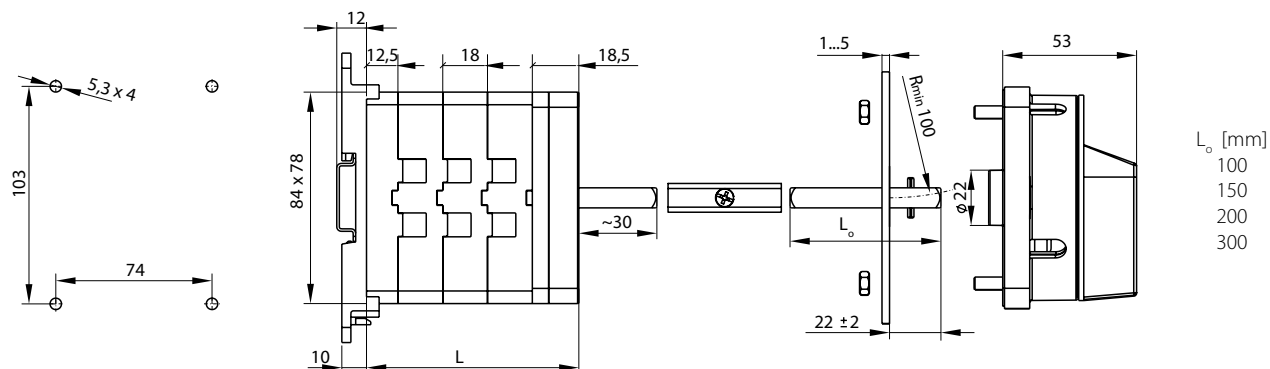

## Technical data

Rated insulation voltage $U_e$	690 V
Rated withstand impulse voltage $U_{imp}$	6 kV
Rated continuous current $I_u$	100 A
Rated operational current $I_e$	100 A
Conventional rated thermal current in the air $I_{th}$	100 A
Conventional rated thermal current in the enclosure $I_{the}$	100 A
Frequency	50/60 Hz
Rated operational current $I_e$ for AC-21A, AC-22A	100 A (230/400/500/690 V)
Rated operational power $P_e$ for AC-23A	18 kW (230 V) 31 kW (400 V) 38 kW (500 V) 50 kW (690 V)
Rated operational power $P_e$ for AC-3	18 kW (230 V) 25 kW (400 V) 30 kW (500 V) 38 kW (690 V)
Switching angle	45°-90°
Short-time short-circuit withstand current $I_{cw}(1s)$	1.7 kA
Rated short-circuit making current $I_{cm}$	2.5 kA
Wire gauge	16...35 mm <sup>2</sup> (solid) 16...25 mm <sup>2</sup> (stranded)
Panel mounting	□68
Screws in the terminals	M6
Tightening torque, wires (hold down)	4.4 Nm
Mechanical endurance	3.0 mln (transposition cycles)
Ambient temperature	-40 ... +70°C (work) -40 ... +70°C (storage)
Protection level: PN-EN 60529 to the panel	IP65
Protection level of OB enclosure	IP65
Protection level of the terminals	IP20
Pollution degree EN 60947-1	3
Protection class in OB housing	II
Vibration test (acc. to IEC 60068-2-6)	2...100 Hz (frequency) 13.2 Hz (frequency) ± 1 mm (acceleration amplitude) ±0.7 g (acceleration amplitude)
Shock test (acc. to IEC 60068-2-27)	15 g (peak acceleration) 11 ms (impulse duration)
Damp heat cyclic test (acc. to IEC 60068-2-30)	55°C (ambient temperature) 95% (relative humidity)
Salt mist cyclic test (acc. to IEC 60068-2-52)	severity 1