

Cam switch, panel-mounted, ŁK15 P



Ordering code

ŁK15- \

Mounting

- P01** with legend plate and knob IP41
- P02** yellow legend plate, red knob IP41
- P03** front I (IP65)
- P04** front I yellow-red (IP65)
- P07** front III (IP65), lockable
- P08** front III yellow-red (IP65), lockable
- P09** front II (IP65), long black knob
- P10** front II (IP65), long knob, yellow-red

Assembly number

- 1.825** Disconnecter 0-1 (1 - pole)
- 1.828** Disconnecter 0-1 (2 - pole)
- 2.8211** Disconnecter 0-1 (3 - pole)
- 2.8210** Disconnecter 0-1 (4 - pole)
- 3.8220** Disconnecter 0-1 (5 - pole)
- 3.8210** Disconnecter 0-1 (6 - pole)
- 4.8240** Disconnecter 0-1 (7 - pole)
- 4.824** Disconnecter 0-1 (8 - pole)
- 5.8220** Disconnecter 0-1 (9 - pole)
- 5.822** Disconnecter 0-1 (10 - pole)
- 6.8210** Disconnecter 0-1 (11 - pole)
- 6.821** Disconnecter 0-1 (12 - pole)
- 7.8220** Disconnecter 0-1 (13 - pole)
- 7.822** Disconnecter 0-1 (14 - pole)
- 8.8270** Disconnecter 0-1 (15 - pole)
- 8.827** Disconnecter 0-1 (16 - pole)
- 3.8368** Reversing switch L-0-P
- 3.83139** 2-speed switch
2 separate windings
2-speed Dahlander switch
- 4.8390** 2-speed Dahlander switch
- 7.8538** 2-speed reversing
Dahlander switch
- 4.831** 3-phase starting switch 0-Y-Δ
- 5.8538** 3-phase starting
reversing switch
- 4.883** Voltmeter selector switch
- 2.4414** Rotary disconnecter 0-1
- 2.8445** Control switch 0-1-2-3
- 1.834** Disconnecter 1-0-2 (1 - pole)
- 2.8338** Disconnecter 1-0-2 (2 - pole)
- 3.8380** Disconnecter 1-0-2 (3 - pole)
- 4.8396** Disconnecter 1-0-2 (4 - pole)
- 5.8380** Disconnecter 1-0-2 (5 - pole)
- 6.8380** Disconnecter 1-0-2 (6 - pole)
- 7.8380** Disconnecter 1-0-2 (7 - pole)
- 8.8380** Disconnecter 1-0-2 (8 - pole)
- 9.8380** Disconnecter 1-0-2 (9 - pole)
- 10.8380** Disconnecter 1-0-2 (10 - pole)



Components

Fronts of cam switches

Front I ŁK-1406

Front II ŁK-1407

Front III ŁK-1408 (padlockable)

Dimensions

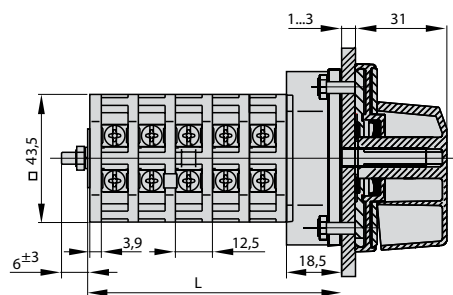
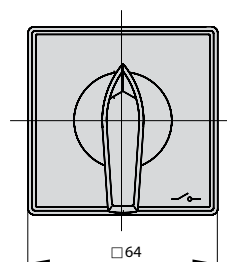
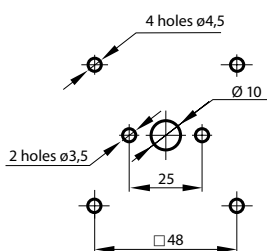

Number of segments	L [mm]
1	35,0
2	47,5
3	60,0
4	72,5
5	85,0
6	97,5
7	110,0
8	122,5

* It is possible to increase the length by a multiple of 12.5 [mm]

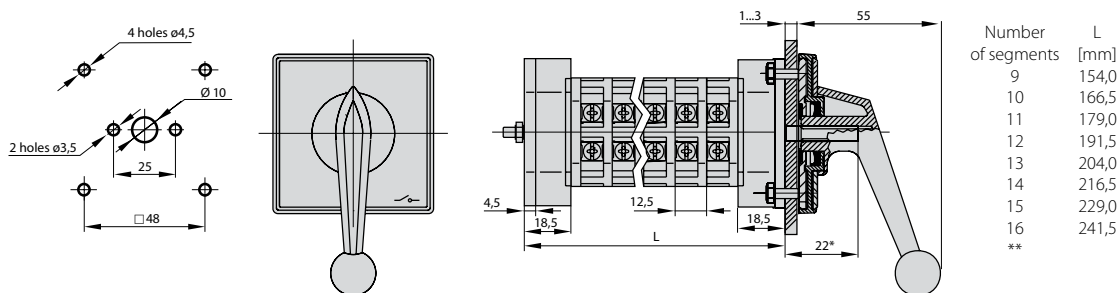

Number of segments	L [mm]
9	154,0
10	166,5
11	179,0
12	191,5
13	204,0
14	216,5
15	229,0
16	241,5
**	

* It is possible to increase the length by a multiple of 12.5 [mm]

** If necessary the number of segments can be increased to 21

Number of segments in the switch

1 ... 16

Technical data (continuous work)

Rated insulation voltage U_i	500 V
Rated withstand impulse voltage U_{imp}	4 kV
Rated continuous current $I_u=I_{th}$	16 A
Rated operational current I_g for AC-15	7 A (500 V)
Rated operational current I_g for AC-3	8.7 A (400 V) 8.7 A (500 V)
Rated operational current I_g for AC-4	7 A (400 V) 7 A (500 V)
Short-time short-circuit withstand current $I_{cw}(1s)$	0.5 kA
Rated short-circuit making current I_{cm}	2 kA
Tightening torque, terminals	1.2 Nm
Mechanical endurance	3.0 mln (transposition cycles)
Ambient temperature	-25 ... +70°C (work) -25 ... +70°C (storage)
Wire gauge	1.5...4 mm ²
Protection level: PN-EN 60529 to the panel	IP41 IP65